

HBW

ROUGH IN SPECS. FOR ALL:

- 382-XXX (2-WAY DIVERTER) as of 12/00
- 383-XXX (3-WAY DIVERTER) as of 12/00

If copper adapters are used for installation, remove the bonnet and the three plungers from the diverter body before soldering.

When piping the tub spout, you must use 3/4" pipe or 3/4" copper tubing to the tub spout. HBW does not recommend 1/2" pipe or tubing as this will cause a flow restriction.

We recommend that both inlet feeds are used at all times.

A = Maximum allowable wall thickness for each series (finished wall).

B = Minimum wall thickness = 4-1/4" (finished wall).

| Series# | Name | A |
|-------------------------------|--|----------|
| 04,17,28,29 | Polo, Quartz, Chateau, Milano | 4-5/8" |
| 05,06,15,20,32,33,34,86,87,88 | Loire,Victorian, Chelsea, Mayfair, Palace, and Colisee | 4-1/2" |
| 10 | Olympie | 4-11/16" |
| 24 | Mandoline Crystal | 4-7/8" |
| 26 | Cristalsinn I,II,III | 5" |

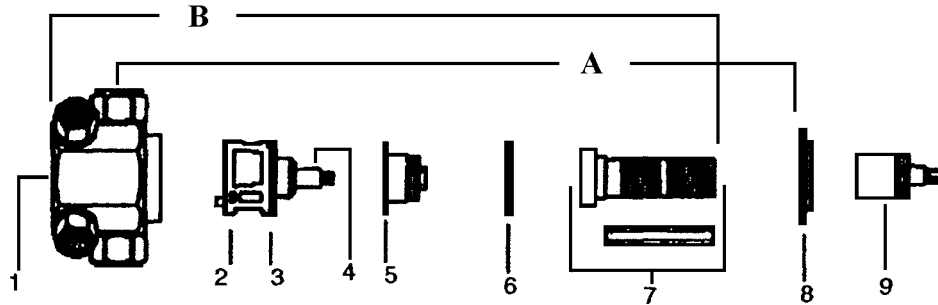
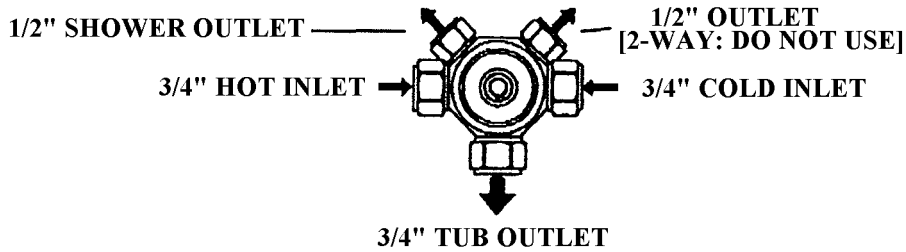

| | | | |
|---------------|----------------|------------------|----------------|
| 1. 80-045-000 | 2-way diverter | 5. 80-187A-000 | Bonnet |
| 80-043-000 | 3-way diverter | 6. 80-382-RNUT | Retaining nut |
| 2. 80-188-000 | Cartridge | 7. 86-645-ML | Brass adapter |
| 3. 80-185-000 | O-ring | 8. -80-041L-XXX | Sliding flange |
| 4. 80-382-PIN | Pin | 9. 86-646BR-XXXM | Stem adapter |

XXX INDICATES A FINISH IS NECESSARY
— INDICATES A SERIES NUMBER IS NECESSARY