

HBW

ROUGH IN SPECS. FOR ALL:

- 382-XXX (2-WAY DIVERTER) as of 12/00
- 383-XXX (3-WAY DIVERTER) as of 12/00

If copper adapters are used for installation, remove the bonnet and the three plungers from the diverter body before soldering.

When piping the tub spout, you must use 3/4" pipe or 3/4" copper tubing to the tub spout. HBW does not recommend 1/2" pipe or tubing as this will cause a flow restriction.

We recommend that both inlet feeds are used at all times.

A = Maximum allowable wall thickness for each series (finished wall).

B = Minimum wall thickness = 4-1/4" (finished wall).

Series#	Name	A
04,17,28,29	Polo, Quartz, Chateau, Milano	4-5/8"
05,06,15,20,32,33,34,86,87,88	Loire,Victorian, Chelsea, Mayfair, Palace, and Colisee	4-1/2"
10	Olympie	4-11/16"
24	Mandoline Crystal	4-7/8"
26	Cristalsinn I,II,III	5"

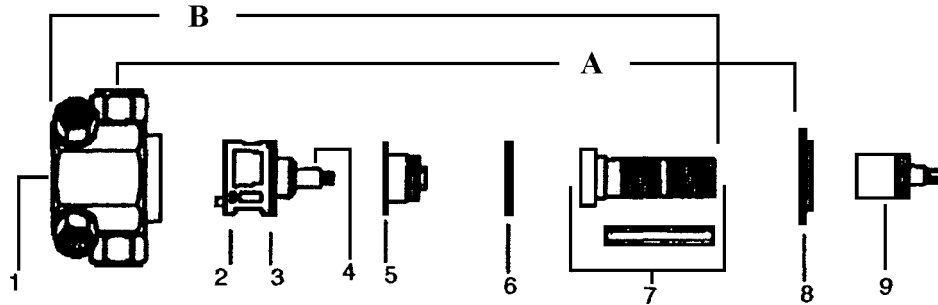
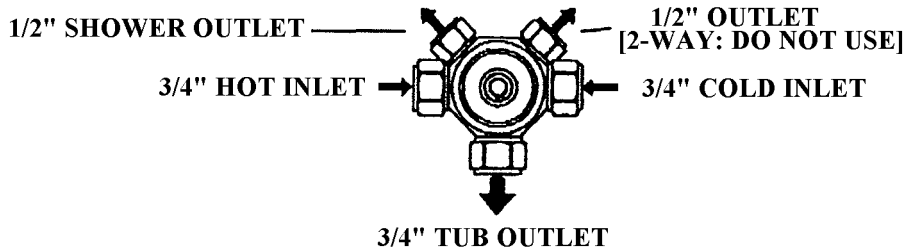

1. 80-045-000	2-way diverter	5. 80-187A-000	Bonnet
80-043-000	3-way diverter	6. 80-382-RNUT	Retaining nut
2. 80-188-000	Cartridge	7. 86-645-ML	Brass adapter
3. 80-185-000	O-ring	8. -80-041L-XXX	Sliding flange
4. 80-382-PIN	Pin	9. 86-646BR-XXXM	Stem adapter

XXX INDICATES A FINISH IS NECESSARY
— INDICATES A SERIES NUMBER IS NECESSARY